

UNISTIK®3 LANCET INSTRUCTIONS FOR USE 1/2

1. Wash hands thoroughly before and after using the device. Clean the sample site and use personal protective equipment according to your institution guidelines.

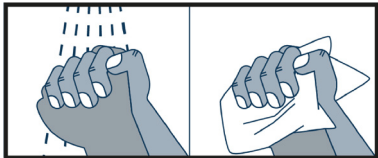

2. Gently rub the finger towards the tip to help promote a good sample volume. **TWIST** off and discard lancet cap.

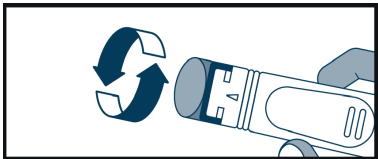

WARNING: Do not pull lancet cap.

UNISTIK®3 LANCET INSTRUCTIONS FOR USE 2/2

3. Press platform firmly against sample site and press the release button. The lancet will automatically retract into body of device. Dispose of the entire device in a suitable sharps container.

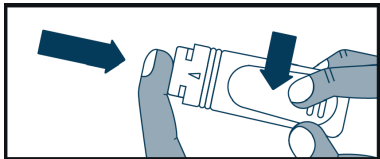

NOTE: The cap is the sterile barrier, do not use if cap was previously removed. For use only on a single patient. Discard entire device after use.

WARNING: Not intended for more than one use. Do not use on more than one patient. Improper use of blood lancets can increase the risk of inadvertent transmission of bloodborne pathogens, particularly in settings where multiple patients are tested.